



## 2 bed detached bungalow to buy

Cypress View, Wheatley Hill, Durham,  
Durham, DH6 3SL

# £179,995

🛏 x 2 🚿 x 1 🚿 x 2

Tenure      Size  
**Freehold      624 sq ft / 58 sq m**

Driveway & Garage parking

Garden

## Property features

- ✓ Beautifully detached bungalow
- ✓ Sunny conservatory
- ✓ Two double bedrooms
- ✓ Large corner plot
- ✓ EPC Rating C

## Key Information

- ✓ Council Tax: Band C
- ✓ EPC Rating: C
- ✓ Heating supply: Gas
- ✓ Electric supply: National Grid
- ✓ Water supply: Direct mains water

## Description

Beautiful Two-Bedroom Detached Bungalow – Wheatley Hill

We are delighted to present this stunning two-bedroom detached bungalow, ideally located in the highly sought-after area of Wheatley Hill. This beautifully maintained home offers spacious living accommodation, modern décor throughout, and sits proudly on a generous, well-kept plot with gardens to three sides.

The property features two well-proportioned double bedrooms with fitted wardrobes, a bright and airy lounge filled with natural light, and a high-quality refitted kitchen fitted with a stylish range of solid wood wall and base units. The contemporary bathroom is presented with a white three-piece suite, and the sunny conservatory provides an additional relaxing space overlooking the gardens. The property further benefits from gas central heating and double glazing throughout.

Externally, the bungalow occupies an impressive corner plot with beautifully landscaped gardens surrounding the property. The outdoor space is filled with mature shrubs, trees, and colourful planting, adding real charm and character. To the front and side, there is a double driveway accessed by double gates, leading to a larger-than-average detached garage equipped with an electric roller shutter door, brick-built store, and an electric vehicle charging point.

This exceptional home is a true credit to its current owners and offers a rare opportunity to purchase a high-quality bungalow in a popular village location close to local schools and amenities.

With its stunning gardens, spacious interior, and excellent position, this property represents an outstanding opportunity. Early viewing is strongly recommended to fully appreciate the quality and charm this delightful bungalow has to offer.

Council Tax Band: C

Tenure: Freehold

Price: £179,995

Property Type: Detached Bungalow

Build Size: 58 sq m

USPs: Garden

Parking: Driveway & Garage

Heating: Gas

Electric: National Grid

Water: Direct mains water

Sewerage: Standard UK domestic

## External Front



## Kitchen

3.89m x 2.79m (12'9" x 9'1")



## Lounge

5.55m x 3.27m (18'2" x 10'8")



## Conservatory

3.20m x 2.16m (10'5" x 7'1")



## Inner Hall



## Bedroom One

4.27m x 2.76m (14'0" x 9'0")



## Bedroom Two

3.31m x 3.08m (10'10" x 10'1")



## Family Bathroom

2.06m x 1.75m (6'9" x 5'8")



## External Side



## External Rear



## Plot



---

## Garage & Driveway



Approx Gross Internal Area  
85 sq m / 910 sq ft

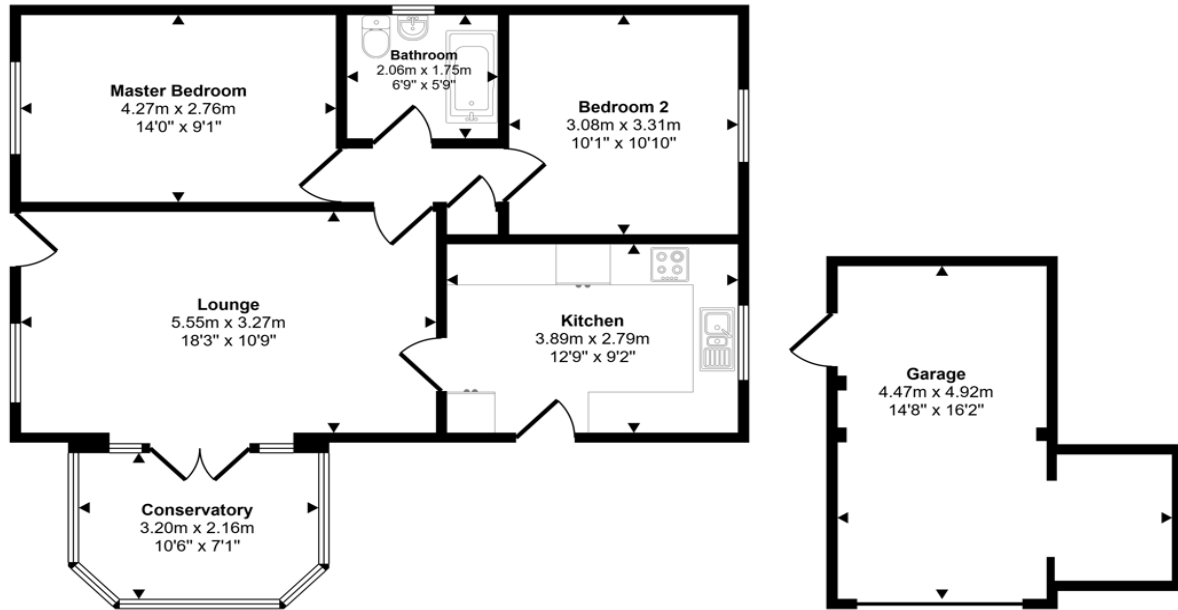

Floorplan  
Approx 68 sq m / 728 sq ft

Garage  
Approx 17 sq m / 182 sq ft

This floorplan is only for illustrative purposes and is not to scale. Measurements of rooms, doors, windows, and any items are approximate and no responsibility is taken for any error, omission or mis-statement. Icons of items such as bathroom suites are representations only and may not look like the real items. Made with Made Snappy 360.

Energy Efficiency Rating		
	Current	Potential
<i>Very energy efficient - lower running costs</i>		
(92-100) <b>A</b>		
(81-91) <b>B</b>		87
(69-80) <b>C</b>	71	
(55-68) <b>D</b>		
(39-54) <b>E</b>		
(21-38) <b>F</b>		
(1-20) <b>G</b>		
<i>Not energy efficient - higher running costs</i>		
<b>England, Scotland &amp; Wales</b>	EU Directive 2002/91/EC	

Cypress View, Wheatley Hill, Durham, Durham, DH6 3SL

Contact your local branch today for more information on this property:

**27-28 Tuesday Market Place, King's Lynn, Norfolk, PE30 1JJ,**  
**TBC<http://www.norfolkpropertyauctions.com>**

These particulars, whilst believed to be accurate are set out as a general outline only for guidance and do not constitute any part of an offer or contract. Intending purchasers should not rely on them as statements of representation of fact, but must satisfy themselves by inspection or otherwise as to their accuracy. No person in this firm's employment has the authority to make or give any representation or warranty in respect of the property.

