



### 3 bed terraced house to buy in L6

Esher Road, Liverpool, Liverpool,  
Merseyside, L6 6DF

**£70,000** Starting Bid

 x3  x1  x1

Tenure

**Freehold**

On Street parking

### Property features

- ✓ Being Sold via Secure Sale online bidding. Terms & Conditions apply
- ✓ Three Bedroom Terrace
- ✓ Freehold
- ✓ Popular Location
- ✓ EPC Rating D

## Key Information

- ✓ Council Tax: Band A
- ✓ EPC Rating: D
- ✓ Heating supply: Other

## Description

Being Sold via Secure Sale online bidding. Terms & Conditions apply. Starting Bid £70,000

Three Bedroom Mid Terrace In need of refurbishment downstairs WC, this property presents an exciting canvas to unleash your creative vision and design aspirations, the property is a stone's throw away from local amenities, schools, parks, and excellent transport links.

Contact us today to arrange your viewing Visit Auctioneers website to make bids!

Council Tax Band: A

Tenure: Freehold

Price: Starting Bid £70,000

Property Type: Terraced House

Parking: On Street

Heating: Other

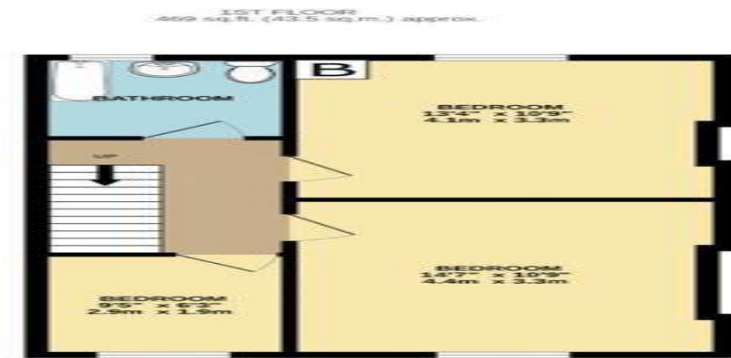
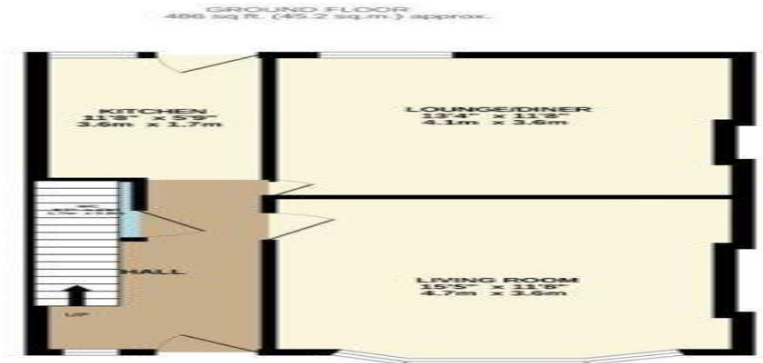

TOTAL FLOOR AREA : 955 sq.ft. (88.7 sq.m.) approx.  
 Whilst every attempt has been made to ensure the accuracy of the floorplan contained here, measurements of doors, windows, rooms and any other items are approximate and no responsibility is taken for any error, omission or mis-statement. The Seller does not advise purchasers not to rely on such floorplans as to their operability or efficiency can be given. Made with Metropix 02/2023

Energy Efficiency Rating		
	Current	Potential
Very energy efficient - lower running costs		
(92-100) <b>A</b>		
(81-91) <b>B</b>		89
(69-80) <b>C</b>		
(55-68) <b>D</b>	63	
(39-54) <b>E</b>		
(21-38) <b>F</b>		
(1-20) <b>G</b>		
Not energy efficient - higher running costs		
England, Scotland & Wales		EU Directive 2002/91/EC

Esher Road, Liverpool, Liverpool, Merseyside, L6 6DF

Contact your local branch today for more information on this property:

**27-28 Tuesday Market Place, King's Lynn, Norfolk, PE30 1JJ,**  
**TBC<http://www.norfolkpropertyauctions.com>**

These particulars, whilst believed to be accurate are set out as a general outline only for guidance and do not constitute any part of an offer or contract. Intending purchasers should not rely on them as statements of representation of fact, but must satisfy themselves by inspection or otherwise as to their accuracy. No person in this firm's employment has the authority to make or give any representation or warranty in respect of the property.

