



## 2 bed apartment to buy in BD16

The Locks, Bingley, West Yorkshire, BD16  
4BG

**£90,000** Starting Bid

 x 2  x 2  x 1

Tenure

**Leasehold**

Allocated parking

## Property features

- ✓ Being Sold via Secure Sale Online Bidding. Terms & Conditions apply.
- ✓ Top Floor Two Bedroom
- ✓ Master Bedroom with En-Suite
- ✓ Allocated Parking
- ✓ EPC Rating D

## Key Information

- ✓ Council Tax: Band D
- ✓ EPC Rating: D
- ✓ Heating supply: Gas

## Description

We are pleased to offer for sale this two bedroom, upper floor apartment situated in a grade II listed mill conversion.

The property benefits from an open plan living room/kitchen area, master bedroom with en-suite and an allocated parking space.

Council Tax Band: D

Tenure: Leasehold

Length of Lease: 96

Annual Ground Rent Amount: £75.00

Annual Service Charge Amount: £3,000.00

Price: Starting Bid £90,000

Property Type: Apartment

Parking: Allocated

Heating: Gas

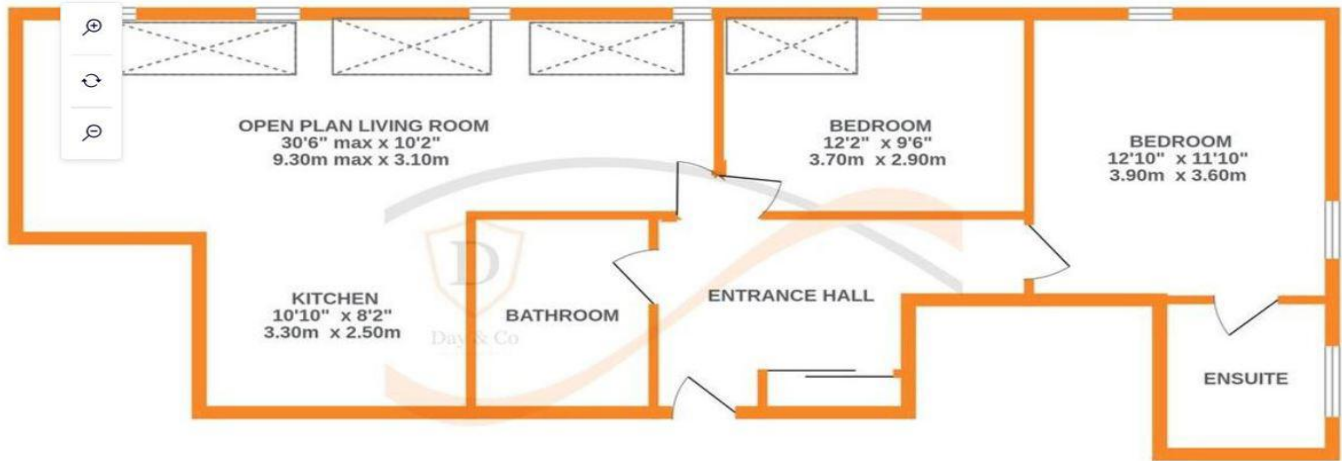

Whilst every attempt has been made to ensure the accuracy of the floorplan contained here, measurements of doors, windows, rooms and any other items are approximate and no responsibility is taken for any error, omission or mis-statement. This plan is for illustrative purposes only and should be used as such by any prospective purchaser. The services, systems and appliances shown have not been tested and no guarantee as to their operability or efficiency can be given.  
Made with Metropix ©2026

Energy Efficiency Rating		
	Current	Potential
<i>Very energy efficient - lower running costs</i>		
(92-100) <b>A</b>		
(81-91) <b>B</b>		
(69-80) <b>C</b>		74
(55-68) <b>D</b>	62	
(39-54) <b>E</b>		
(21-38) <b>F</b>		
(1-20) <b>G</b>		
<i>Not energy efficient - higher running costs</i>		
<b>England, Scotland &amp; Wales</b>	EU Directive 2002/91/EC	

The Locks, Bingley, West Yorkshire, BD16 4BG

Contact your local branch today for more information on this property:

**27-28 Tuesday Market Place, King's Lynn, Norfolk, PE30 1JJ,**  
**TBC<http://www.norfolkpropertyauctions.com>**

These particulars, whilst believed to be accurate are set out as a general outline only for guidance and do not constitute any part of an offer or contract. Intending purchasers should not rely on them as statements of representation of fact, but must satisfy themselves by inspection or otherwise as to their accuracy. No person in this firm's employment has the authority to make or give any representation or warranty in respect of the property.

