



## 1 bed apartment to buy in PO1

Isambard Brunel Road, Portsmouth,  
Portsmouth, Hampshire, PO1 2RX

**£65,000** Starting Bid

 x1  x1  x1

Tenure

**Leasehold**

Off Street parking

## Property features

- ✓ BEING SOLD VIA SECURE SALE  
ONLINE BIDDING - T&Cs APPLY
- ✓ MODERN KITCHEN
- ✓ LIFT ACCESS
- ✓ CENTRAL LOCATION
- ✓ EPC Rating D

## Key Information

- ✓ Council Tax: Band A
- ✓ EPC Rating: D
- ✓ Heating supply: Air Source Heat Pump

## Description

Sold via Secure Sale online bidding. Terms & Conditions apply. Starting Bid £65,000

We are delighted to welcome to the market this modern one bedroom flat in the sought after location of Central Portsmouth. Enterprise House is a development of apartments which boast a high quality modern finish throughout, with high gloss kitchens and contemporary bathrooms.

The location is a stones throw from Portsmouth's main train station and is within walking distance to the University of Portsmouth, city centre and the popular Guildhall Walk strip of bars and restaurants.

Situated perfectly for students or professionals making it the ideal investment opportunity.

Kitchen/Lounge - 5.84m x 3.00m (19'2" x 9'10") - Lounge space with kitchenette area consisting of a range of matching, high gloss wall and base units with plumbing for washing machine, hob and oven, extractor fan overhead, stainless steel sink and drainer unit, space for fridge freezer.

Bedroom - 3.81m x 2.29m (12'6" x 7'6") - Bedroom consisting of carpet flooring, matte painted walls, radiator to wall, double glazed windows

Bathroom - High quality modern bathroom suite comprising of low level w/c and hand wash basin, bath with shower over and glass shower screen, splash-back tiling to walls, chrome heated towel rail.

Portsmouth Council Tax - The local authority is Portsmouth City Council.

BAND : A £1,453.95

Council Tax Band: A

Tenure: Leasehold

Length of Lease: 117

Annual Ground Rent Amount: £250.00

Annual Service Charge Amount: £1,716.00

Price: Starting Bid £65,000

Property Type: Apartment

Parking: Off Street

Construction materials: Brick and block

Roofing type: Flat

Risk of floods and or erosion: No

Flooded in last 5 years: No

Source of flood: Other

Flood defences: No

Planning permissions or proposals for development: No

Coalfield or mining area: No

Listed property: No

Conservation area: No

Public rights of way: No

Adaptions for accessibility: No

Restrictions: No

Required access: No

Heating: Air Source Heat Pump

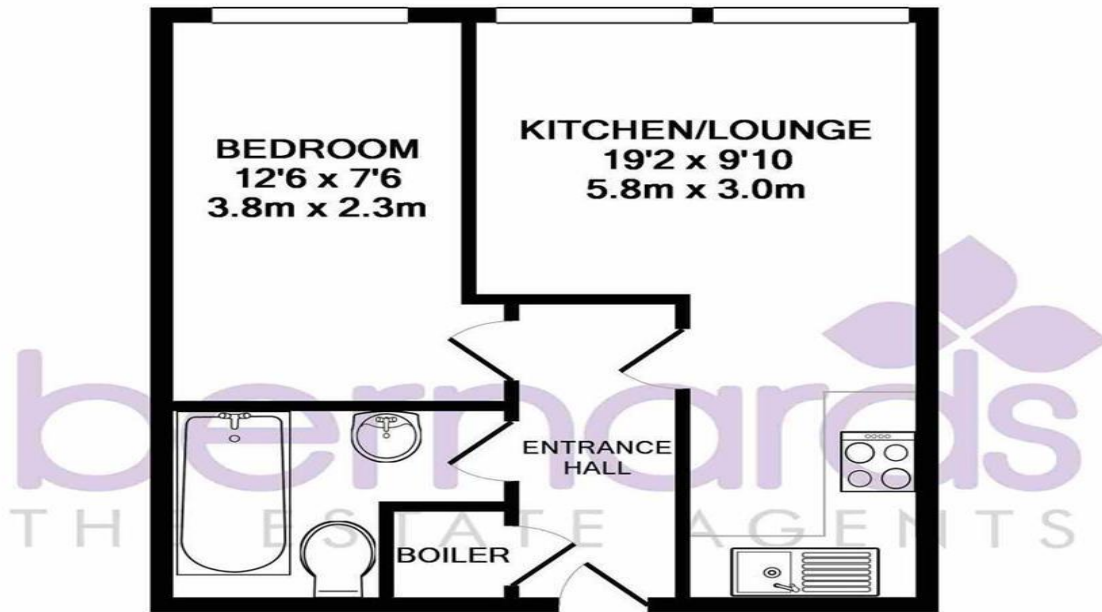

Whilst every attempt has been made to ensure the accuracy of the floor plan contained here, measurements of doors, windows, rooms and any other items are approximate and no responsibility is taken for any error, omission, or mis-statement. This plan is for illustrative purposes only and should be used as such by any prospective purchaser. The services, systems and appliances shown have not been tested and no guarantee as to their operability or efficiency can be given  
 Made with Metropix ©2016

Energy Efficiency Rating		
	Current	Potential
<i>Very energy efficient - lower running costs</i>		
(92-100) <b>A</b>		
(81-91) <b>B</b>		
(69-80) <b>C</b>		
(55-68) <b>D</b>	59	59
(39-54) <b>E</b>		
(21-38) <b>F</b>		
(1-20) <b>G</b>		
<i>Not energy efficient - higher running costs</i>		
<b>England, Scotland &amp; Wales</b>	EU Directive 2002/91/EC	

Isambard Brunel Road, Portsmouth, Portsmouth, Hampshire, PO1 2RX

Contact your local branch today for more information on this property:

**27-28 Tuesday Market Place, King's Lynn, Norfolk, PE30 1JJ,**  
**TBC<http://www.norfolkpropertyauctions.com>**

These particulars, whilst believed to be accurate are set out as a general outline only for guidance and do not constitute any part of an offer or contract. Intending purchasers should not rely on them as statements of representation of fact, but must satisfy themselves by inspection or otherwise as to their accuracy. No person in this firms employment has the authority to make or give any representation or warranty in respect of the property.

