



## HMO in SO15

Berkeley Close, Southampton, Hampshire,  
SO15 2TR

**£270,000** Starting Bid

Tenure

**Freehold**

Allocated parking

## Property features

- ✓ TERRACED TOWNHOUSE
- ✓ HMO WITH TENANTS IN PLACE
- ✓ SOUGHT AFTER LOCATION
- ✓ GARAGE & ALLOCATED PARKING
- ✓ FOUR DOUBLE BEDROOMS

## Description

**\*\*Being Sold Via Secure Sale Online Bidding. Terms & Conditions apply.\*\***

We are delighted to present this spacious townhouse in the popular location of Polygon, Southampton. This fantastic property boasts four bedrooms, a large bathroom and en-suite to the principal bedroom, a garage and allocated parking.

Currently Operating as a fully licensed HMO investment property.

Income Currently;

Room 1 - £500pcm (short term 10 week lease in place, potential to increase to £550pcm)

Room 2 - £500pcm (short term 10 week lease in place, potential to increase to £550pcm)

Room 3 - £700pcm

Room 4 - Let for £475pcm and the tenant moves in on the 26th May 2026

Entrance Hall:

Smooth plaster ceiling to coving, access to sitting room and kitchen, stairs leading to first floor, wood effect flooring.

Sitting Room: (15'5" x 12'7")

Smooth plaster ceiling to coving, double glazed sliding doors leading to rear garden, radiator, under-stair storage, radiator and wood effect flooring.

Kitchen: (9'1" x 7'3")

Smooth plaster ceiling, double glazed window to front aspect, radiator, a range of wall and base level units with rolled edge work surfaces, built-in gas hob and electric oven with extractor above, sink and drainer with mixer tap, space and plumbing for a fridge/freezer and washing machine.

First Floor Landing:

Smooth plaster ceiling to coving, access to bedrooms and family bathroom, radiator, stairs leading to second floor, carpet flooring.

Bedroom Two: (12'7" x 10'10")

Smooth plaster ceiling to coving, double glazed window to rear aspect, radiator and carpet flooring.

Bedroom Three: (12'7" x 7'3")

Smooth plaster ceiling to coving, double glazed window to rear aspect, radiator and carpet flooring.

Family Bathroom: (7'9" x 4'9")

Smooth plaster ceiling, suite comprising panel enclosed bath with shower over, low level WC, hand wash basin, radiator.

Second Floor Landing:

Smooth plaster ceiling, access to bedrooms and loft via a hatch, storage cupboard, radiator and carpet flooring.

Principal Bedroom: (12'7" x 10'10")

Smooth plaster ceiling to coving, double glazed window to rear aspect, radiator and carpet flooring.

En-Suite:

Suite comprising shower cubicle, low level WC, hand wash basin and radiator.

Bedroom Four: (12'7" x 7'3")

Smooth plaster ceiling to coving, double glazed window to rear aspect, radiator and carpet flooring.

Externally:

There is allocated parking for one car and a single garage in a block with an up and over door. There is also a private rear garden enclosed with fence panel borders.

Price: Starting Bid £270,000

Property Type: HMO

Business Type: Residential Investments

Parking: Allocated, Garage

## Description

A spacious townhouse in the popular location of Polygon, Southampton. This fantastic property boasts four bedrooms, large bathroom and en-suite to the principal bedroom, a garage and allocated parking. Currently occupied as a HMO with four tenants in place.

---

## Location

In the popular location of Polygon, Southampton.

---

## Tenure

Title number; HP526220 - Freehold

---

## EPC

Rating C

---

## Additional Information

For further information please contact our office direct on 0191 737 1154, or alternatively via e-mail on [commercial@pattinson.co.uk](mailto:commercial@pattinson.co.uk). With regards to viewing the subject property, this is to be done strictly by appointment through Keith Pattinson Commercial department. Please contact us to arrange an internal inspection, or to register your interest.

GROUND FLOOR  
325 sq.ft. (30.2 sq.m.) approx.

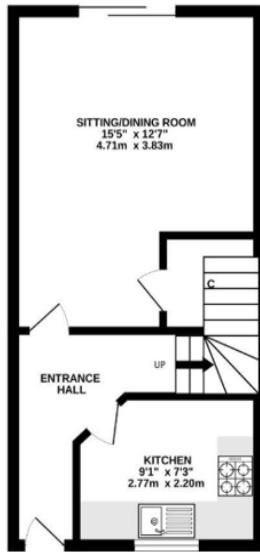

1ST FLOOR  
325 sq.ft. (30.2 sq.m.) approx.



2ND FLOOR  
325 sq.ft. (30.2 sq.m.) approx.

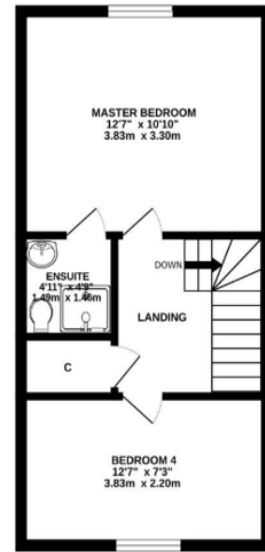

TOTAL FLOOR AREA: 974 sq.ft. (90.5 sq.m.) approx.

Whilst every attempt has been made to ensure the accuracy of the floorplan contained here, measurements of doors, windows, rooms and any other items are approximate and no responsibility is taken for any error, omission or mis-statement. This plan is for illustrative purposes only and should be used as such by any prospective purchaser. The services, systems and appliances shown have not been tested and no guarantee as to their operability or efficiency can be given.  
Made with Metropix ©2026

Berkeley Close, Southampton, Hampshire, SO15 2TR

Contact your local branch today for more information on this property:

**27-28 Tuesday Market Place, King's Lynn, Norfolk, PE30 1JJ,**  
**TBC<http://www.norfolkpropertyauctions.com>**

These particulars, whilst believed to be accurate are set out as a general outline only for guidance and do not constitute any part of an offer or contract. Intending purchasers should not rely on them as statements of representation of fact, but must satisfy themselves by inspection or otherwise as to their accuracy. No person in this firm's employment has the authority to make or give any representation or warranty in respect of the property.

