

Retail in BL1

Bridge Street, Bolton, Greater Manchester,
BL1 2EG

£80,000 Starting Bid

Tenure

Freehold

Property features

- ✓ Freehold retail property
- ✓ Suitable for a variety of commercial uses
- ✓ Vacant Possession
- ✓ Prominent Bolton location
- ✓ Ideal for investors or

Description

FOR SALE BY AUCTION: terms and conditions apply.

This freehold retail property on Bridge Street offers an excellent opportunity for investors or owner-occupiers seeking commercial premises in a central Bolton location. The property is suitable for a variety of retail or commercial uses, subject to the necessary permissions.

Situated within a well-established area, the property benefits from good visibility and convenient access to Bolton town centre, surrounding businesses, and transport links.

Location Highlights:

- Located on Bridge Street in Bolton
- Close to Bolton town centre
- Surrounded by local businesses and amenities
- Good public transport and road connections
- Convenient access to surrounding areas

Price: Starting Bid £80,000

Property Type: Retail

Business Type: Other/Unspecified

Description

This freehold retail property on Bridge Street offers an excellent opportunity for investors or owner-occupiers seeking commercial premises in a central Bolton location.

Tenure

Title number GM350900 - Freehold

Location

Situated within a well-established area, the property benefits from good visibility and convenient access to Bolton town centre, surrounding businesses, and transport links.

EPC

Rating E

Additional Information

For further information please contact our office direct on 0191 737 1154, or alternatively via e-mail on commercial@pattinson.co.uk. With regards to viewing the subject property, this is to be done strictly by appointment through Keith Pattinson Commercial department. Please contact us to arrange an internal inspection, or to register your interest.

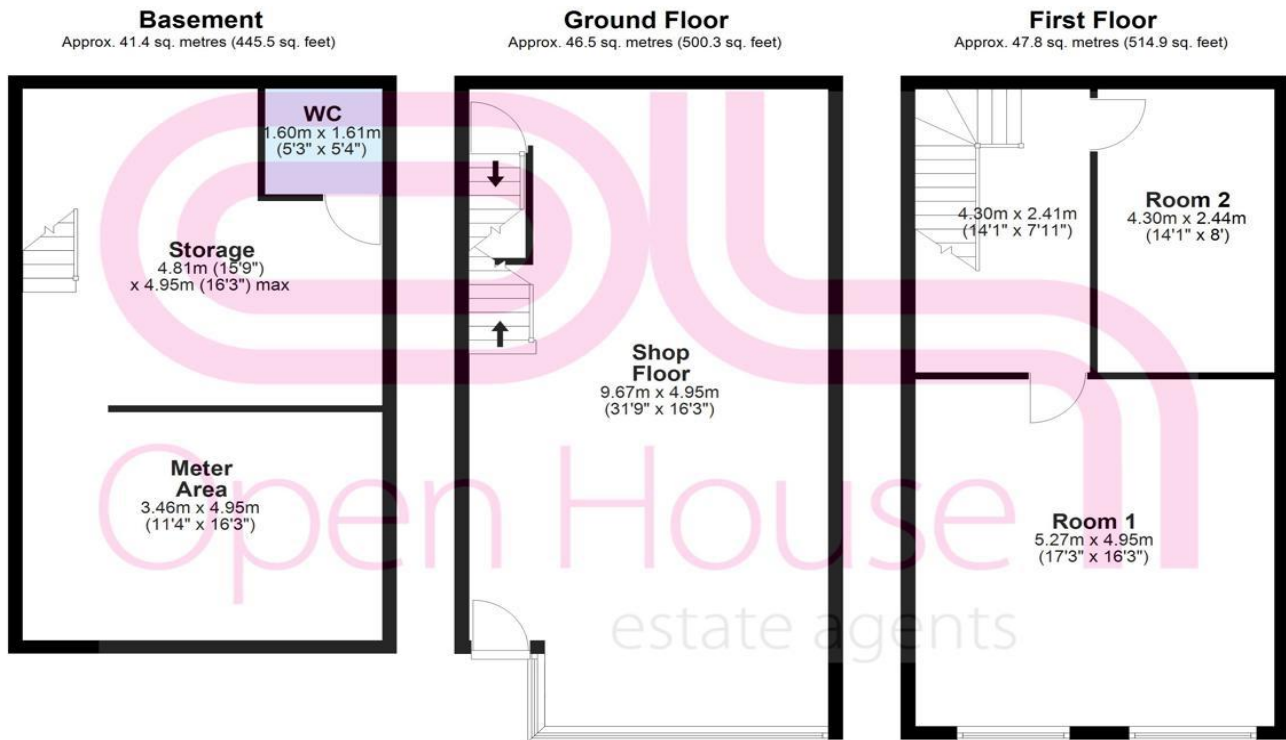

Total area: approx. 135.7 sq. metres (1460.6 sq. feet)

Bridge Street, Bolton, Greater Manchester, BL1 2EG

Contact your local branch today for more information on this property:

27-28 Tuesday Market Place, King's Lynn, Norfolk, PE30 1JJ,
TBC<http://www.norfolkpropertyauctions.com>

These particulars, whilst believed to be accurate are set out as a general outline only for guidance and do not constitute any part of an offer or contract. Intending purchasers should not rely on them as statements of representation of fact, but must satisfy themselves by inspection or otherwise as to their accuracy. No person in this firm's employment has the authority to make or give any representation or warranty in respect of the property.

