



### 3 bed semi-detached house to buy in NE5

Stocksfield Avenue, Fenham, Newcastle upon Tyne, Tyne and Wear, NE5 2DX

**£210,000** Offer Over

 x3  x1  x2

Tenure

**Freehold**

Driveway parking

### Property features

- ✓ Semi Detached House - Three Bedrooms
- ✓ Sought After Location
- ✓ Gas Central Heating and Double Glazing
- ✓ Good Sized Garden
- ✓ EPC Rating D

## Key Information

- ✓ Council Tax: Band B
- ✓ EPC Rating: D
- ✓ Heating supply: Gas

## Description

Three Bedroom Semi-Detached House – Stocksfield Avenue, Fenham, Newcastle upon Tyne

Located on the highly sought-after Stocksfield Avenue in Fenham, this attractive three bedroom semi-detached property offers generous living space, making it an ideal family home. The ground floor accommodation comprises a welcoming entrance hallway, a bright and spacious lounge, a separate dining room perfect for entertaining, a fitted kitchen, and a convenient ground floor WC. To the first floor, there are three well-proportioned bedrooms and a family bathroom.

Externally, the property benefits from a driveway providing off-street parking, along with a private garden—ideal for outdoor relaxation and family use.

Early viewing is highly recommended to appreciate the location and accommodation on offer.

Council Tax Band: B

Tenure: Freehold

Price: Offer Over £210,000

Property Type: Semi-detached house

Parking: Driveway

Heating: Gas

## Entrance Hall

---

### Lounge

4.20m x 3.70m (13'9" x 12'1")



### Dining Room

4.50m x 3.60m (14'9" x 11'9")

Open plan to kitchen.

### Kitchen

4.50m x 2.20m (14'9" x 7'2")



## WC

---

## Stairs to First Floor

---

### Bedroom One

4.40m x 3.10m (14'5" x 10'2")



### Bedroom Two

4.40m x 3.20m (14'5" x 10'5")



## Bedroom Three

2.70m x 2.20m (8'10" x 7'2")



---

## Bathroom



---

## Garage

Just storage.

---

## Driveway

---

## Garden



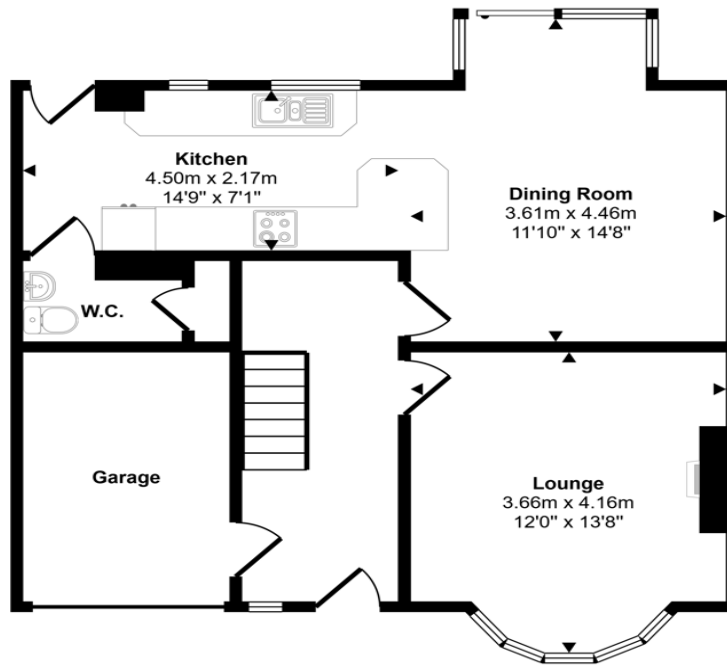

**Ground Floor**  
**Approx 61 sq m / 656 sq ft**

This floorplan is only for illustrative purposes and is not to scale. Measurements of rooms, doors, windows, and any items are approximate and no responsibility is taken for any error, omission or mis-statement. Icons of items such as bathroom suites are representations only and may not look like the real items. Made with Made Snappy 360.

Energy Efficiency Rating		
	Current	Potential
<i>Very energy efficient - lower running costs</i>		
(92-100) <b>A</b>		
(81-91) <b>B</b>		
(69-80) <b>C</b>		78
(55-68) <b>D</b>	65	
(39-54) <b>E</b>		
(21-38) <b>F</b>		
(1-20) <b>G</b>		
<i>Not energy efficient - higher running costs</i>		
<b>England, Scotland &amp; Wales</b>	EU Directive 2002/91/EC	

Stocksfield Avenue, Fenham, Newcastle upon Tyne, Tyne and Wear, NE5 2DX

Contact your local branch today for more information on this property:

**27-28 Tuesday Market Place, King's Lynn, Norfolk, PE30 1JJ,**  
**TBC<http://www.norfolkpropertyauctions.com>**

These particulars, whilst believed to be accurate are set out as a general outline only for guidance and do not constitute any part of an offer or contract. Intending purchasers should not rely on them as statements of representation of fact, but must satisfy themselves by inspection or otherwise as to their accuracy. No person in this firm's employment has the authority to make or give any representation or warranty in respect of the property.

