



3 bed terraced house to buy in

Mortimer Chase, East Hartford,
Cramlington, Northumberland, NE23 3ED

£149,950

🏠 x3 🚗 x1 🚲 x1

Tenure

Freehold

Property features

- ✓ Three bedrooms
- ✓ Conservatory
- ✓ Mid-terrace
- ✓ Ideal for first time buyers
- ✓ EPC Rating C

On Street parking

Key Information

- ✓ Council Tax: Band A
- ✓ EPC Rating: C
- ✓ Heating supply: Gas

Description

A well-presented three bedroom mid terrace home, situated in the popular area of East Hartford, Cramlington.

This attractive property offers spacious and modern living throughout, featuring a large lounge and an impressive contemporary kitchen diner—perfect for family life and entertaining. A bright conservatory provides additional living space and overlooks the low maintenance rear garden.

To the first floor, there are three generously sized bedrooms along with a modern family bathroom.

Externally, the property has easy to maintain gardens, all set within a quiet and desirable location.

Ideal for first-time buyers, this home combines comfort, space, and convenience in a sought-after setting.

Council Tax Band: A

Tenure: Freehold

Price: £149,950

Property Type: Terraced House

Parking: On Street

Heating: Gas

Living Room



Kitchen



Conservatory



Bedroom 1



Bedroom 2



Bathroom



Bedroom 3



Approx Gross Internal Area
96 sq m / 1028 sq ft

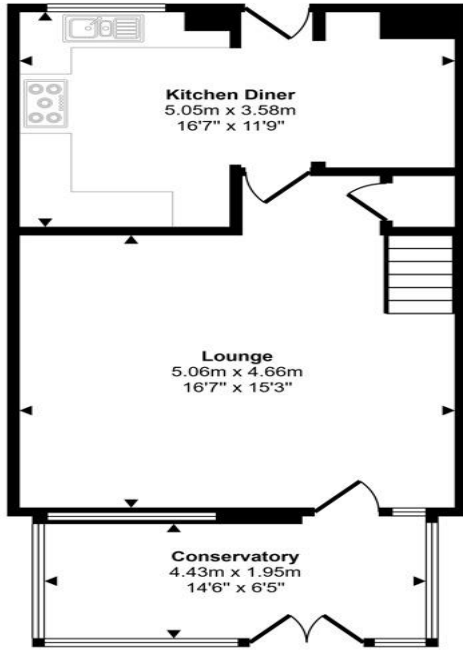

Ground Floor
Approx 52 sq m / 565 sq ft

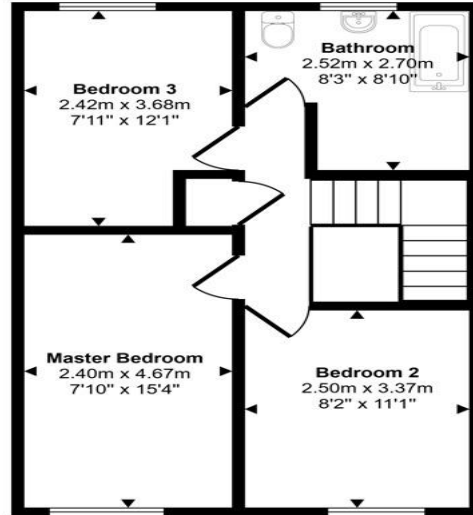

First Floor
Approx 43 sq m / 463 sq ft

This floorplan is only for illustrative purposes and is not to scale. Measurements of rooms, doors, windows, and any items are approximate and no responsibility is taken for any error, omission or mis-statement. Icons of items such as bathroom suites are representations only and may not look like the real items. Made with Made Snappy 360.

Energy Efficiency Rating		
	Current	Potential
<i>Very energy efficient - lower running costs</i>		
(92-100) A		
(81-91) B		
(69-80) C	76	80
(55-68) D		
(39-54) E		
(21-38) F		
(1-20) G		
<i>Not energy efficient - higher running costs</i>		
England, Scotland & Wales	EU Directive 2002/91/EC	

Mortimer Chase, East Hartford, Cramlington, Northumberland, NE23 3ED

Contact your local branch today for more information on this property:

27-28 Tuesday Market Place, King's Lynn, Norfolk, PE30 1JJ,
TBC<http://www.norfolkpropertyauctions.com>

These particulars, whilst believed to be accurate are set out as a general outline only for guidance and do not constitute any part of an offer or contract. Intending purchasers should not rely on them as statements of representation of fact, but must satisfy themselves by inspection or otherwise as to their accuracy. No person in this firm's employment has the authority to make or give any representation or warranty in respect of the property.

